



DelStar

Series 55

INTRODUCING

The all new multi position
DelStar Series 55 Starter Motor
Designed to replace Delco 39MT™
Mitsubishi PGR, Denso R5 and
Prestolite Titan™ 105

ONE STARTER MOTOR

covers better than **90%** of the

HEAVY DUTY TRUCK market

and is backed by a 3 year unlimited mileage
warranty

200-39102

12V, 5.5kW, CW, 11T

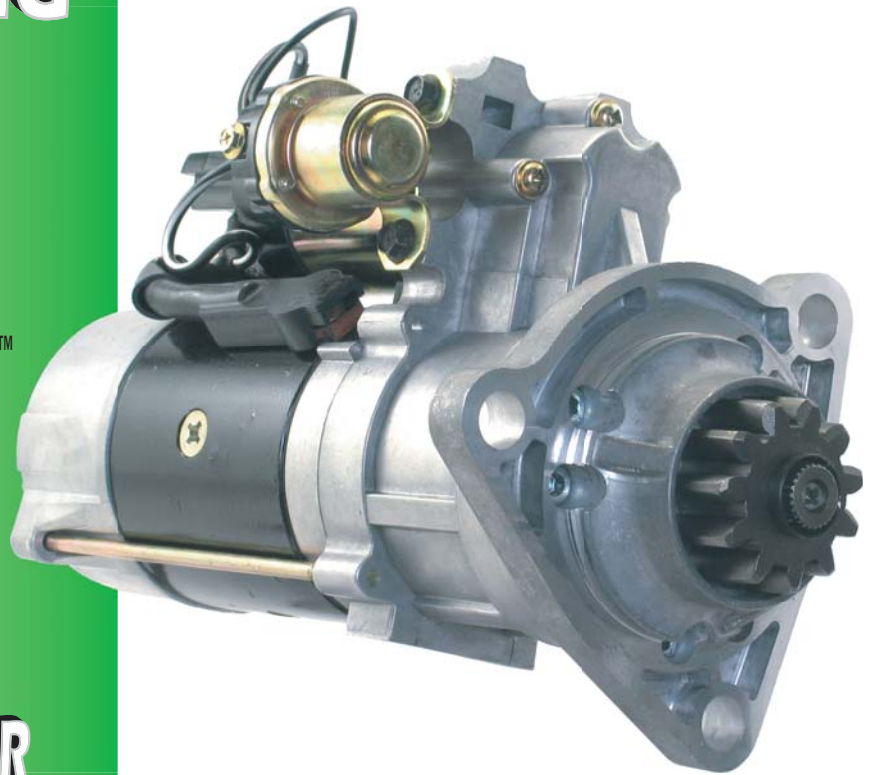

FEATURES

- Planetary Gear Reduction for maximum torque and reliability
- Rotatable multi position Drive End Housing reduces part numbers and inventory
- Lever Housing is designed to allow the Integral Magnetic Switch to be mounted in one of four different positions
- Jump Start Protection solenoid
- Solid link solenoid prevents welding of contacts
- Suitable for wet clutch applications
- Over Crank Protection

Dixie Electric Ltd.
517 Basaltic Road
Concord, ON.
Canada L4K 4W8

Tel.: (905) 879-0533
Fax: (905) 879-0532
E-Mail: sales@dixie-electric.com
Web Site: www.dixie-electric.com

Dixie Electric Inc.
17100 Medina Road, Suite 100
Minneapolis, MN.
U.S.A. 55447-1249

Tel.: (763) 475-6629
Fax: (763) 475-6635
E-Mail: mn.sales@dixie-electric.com
Web Site: www.dixie-electric.com



200-39102

12V, 5.5kW, CW, 11T

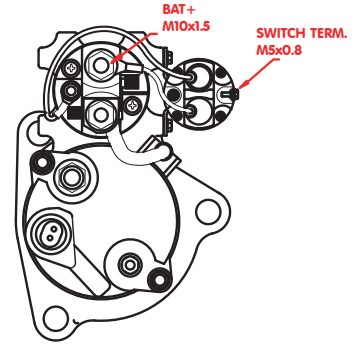
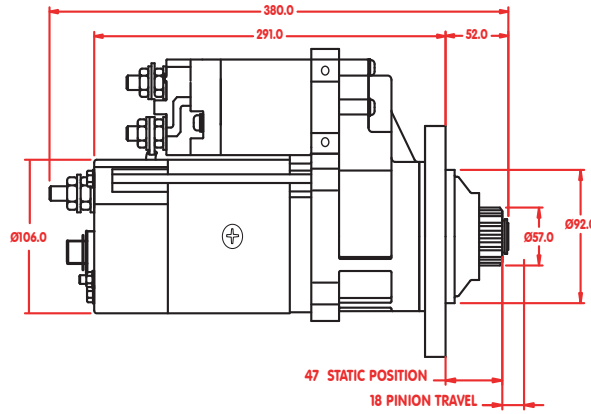
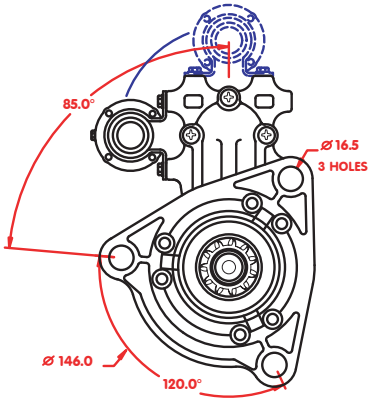

Freightliner, Sterling and Western Star

Cat C10, C12, C15
 Cat C11, C13, C15 Acert
 Cummins ISX, ISM, N14
 DDC 60 Series

International

Cummins ISM, ISX

Volvo

Cummins ISX

As supplied

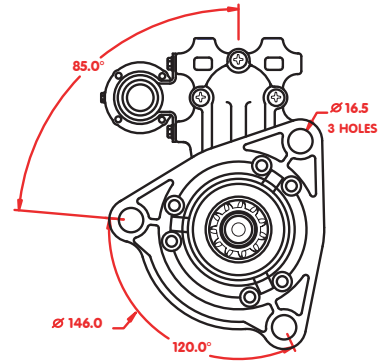

Peterbilt and Kenworth

Cat C10, C12
 Cat C9, C11 Acert
 Cat C13, C15 Acert
 Cummins ISM
 Cummins ISX

Reposition switch
 from 9:00 to 12:00
 O'clock

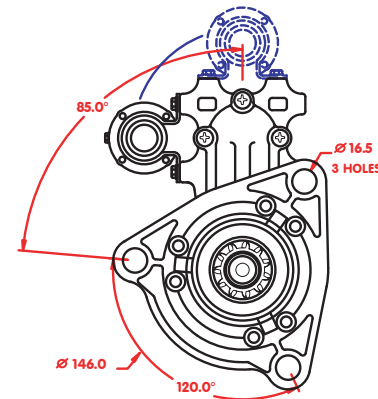

Mack

E-7

Reposition drive
 end housing to 55°

